

# DATA SHEET

## UM 501 W 3m

394-600012-00000



- Water-cooled standard MIG/MAG welding torch
- Robust hose package
- Ergonomic grip with ball joint
- Anti-kink spring on both the welding torch and the connection
- Type-related standard consumables
- **Equipment as supplied (steel wire Ø 1.2):**
  - Gas nozzle, conical, Ø 16 mm; 76 mm
  - Gas diffuser, "Longlife", 28 mm
  - Contact tip M8 x 30 mm; Ø 1.2 mm
  - Contact tip holder M8 x 25 mm
- **Recommendation:**
  - For feeding steel wires, we recommend using a steel liner with a capillary tube
  - For feeding CrNi, aluminium, flux-cored and CuSi wires, we recommend a PA combined liner with a guide tube (alternatively you can use a Teflon or carbon Teflon liner)

Duty cycle CO2	500 A / 100 %
Duty cycle M21	450 A / 100 %
Wire Ø	0.8 mm - 1.6 mm
Connection poles	Euro torch connector
Torch connection	Euro torch connector
Hose package length	3 m
Test mark	CE UK CA EAC

# DATA SHEET

## Consumables

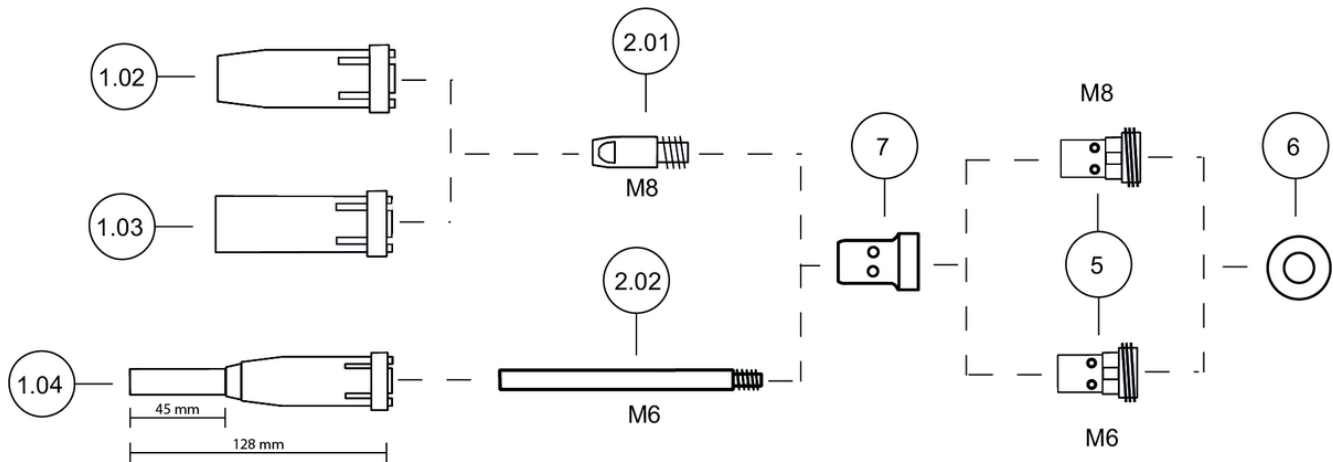

Item	Item no.	Designation
1.02	394-000436-00000	GN Eco Ø=14mm L=76mm MIG 401/501. Gas nozzle, highly conical
1.02	394-000435-00000	GN Eco Ø=16mm L=76mm MIG 401/501. Gas nozzle, conical
1.03	394-000437-00000	GN Eco Ø=19mm L=76mm MIG 401/501. Gas nozzle, cylindrical
1.04	394-000711-00000	GN Eco Ø=11mm L=128 mm MIG 401/501. Narrow-gap gas nozzle
2.01	394-016120-00000	CT Eco M8x30 E-Cu Ø=1,6mm Alu. Contact tip, aluminium welding
2.01	394-000456-00000	CT Eco M8x30 E-Cu Ø=1.6mm. Contact tip
2.01	394-016118-00000	CT Eco M8x30 E-Cu Ø=1,2mm Alu. Contact tip, aluminium welding
2.01	394-016117-00000	CT Eco M8x30 E-Cu Ø=1,0mm Alu. Contact tip, aluminium welding
2.01	394-016115-00000	CT Eco M8x30 E-Cu Ø=0,8mm Alu. Contact tip, aluminium welding
2.01	394-000458-00000	CT Eco M8x30 CuCrZr Ø=1.6mm. Contact tip
2.01	394-000452-00000	CT Eco M8x30 CuCrZr Ø=1.2mm. Contact tip
2.01	394-000450-00000	CT Eco M8x30 CuCrZr Ø=1mm. Contact tip
2.01	394-000942-00000	CT Eco M8x30 E-Cu Ø=1.2mm. Contact tip
2.01	394-000941-00000	CT Eco M8x30 E-Cu Ø=1mm. Contact tip
2.01	394-000447-00000	CT Eco M8x30 E-Cu Ø=0.8mm. Contact tip
2.01	394-014024-00000	CT Eco M8x30 CuCrZr Ø=0.8mm. Contact tip
2.02	394-003059-00000	CT M6 L83 1.2 E-Cu. Narrow-gap contact tip
2.02	394-000707-00000	CT M6-L83-AD6 0.8-1.0. Narrow-gap contact tip
5	394-000438-00000	CTH Eco M8x25mm MIG 401/501. Contact tip holder
5	394-000439-00000	CTH Eco M6x25mm MIG 401/501. Contact tip holder for narrow-gap contact tip
6	394-000761-00000	ISO UM 401/501 Eco. Insulating disk
7	394-000959-00000	GASVERTEILER KERAMIK. Gas diffuser, ceramic
7	394-011628-00000	GD Eco Longlife MIG 401/501. Gas diffuser, long life
7	394-000948-00000	GD Eco L=28 mm, MIG 401/501. Gas diffusers
-	094-013802-00005	LPTFE COMBI 2.7mm x 4.7mm 5m. Combined liner, Teflon
-	094-013802-00004	LPTFE COMBI 2.7mm x 4.7mm 4m. Combined liner, Teflon
-	094-013802-00000	LPTFE COMBI 2.7mm x 4.7mm 3m. Combined liner, Teflon
-	094-013801-00005	LPTFE COMBI, D=2,0 x 4,0 mm, 5 m. Combined liner, Teflon
-	094-013801-00004	LPTFE COMBI, D=2,0 x 4,0 mm, 4 m. Combined liner, Teflon
-	094-013801-00000	LPTFE COMBI 2.0mm x 4.0mm 3m. Combined liner, Teflon
-	094-013800-00005	LPTFE COMBI, D=1,5 x 4,0 mm, 5 m. Combined liner, Teflon
-	094-013800-00004	LPTFE COMBI, D=1,5 x 4,0 mm, 4 m. Combined liner, Teflon
-	094-013800-00000	LPTFE COMBI 1.5mm x 4.0mm 3m. Combined liner, Teflon
-	094-013075-00501	LSTC 1.5mm x 3.8mm 4.6m. Steel liner, insulated
-	094-013074-00501	LSTC 1.5mm x 3.8mm 3.6m. Steel liner, insulated
-	094-014221-00501	LSTC 1.5mm x 3.8mm 5.6m. Steel liner, insulated

Item	Item no.	Designation
-	094-007239-00501	LSTC 2.0mm x 4.6mm 3.6m. Steel liner, insulated
-	094-014224-00501	LSTC 2.0mm x 4.6mm 5.6m. Steel liner, insulated
-	094-013664-00502	LSTC 2.4mm x 4.6mm 5.6m. Steel liner, insulated
-	094-013663-00502	LSTC 2.4mm x 4.6mm 4.6m. Steel liner, insulated
-	094-013662-00502	LSTC 2.4mm x 4.6mm 3.6m. Steel liner, insulated
-	094-014223-00501	LSTC 2.0mm x 4.6mm 4.5m. Steel liner, insulated
-	394-000469-00000	TTOOL. Centring tool for narrow-gap contact tip
-	094-013967-00000	4,0MMX1,0MM. O-ring for Euro torch connector
-	098-005149-00000	O-Ring Picker. O-Ring Picker