

## DATA SHEET

### GuideTube L=102 mm, Ø 4,4 x 5 mm

094-020064-00000

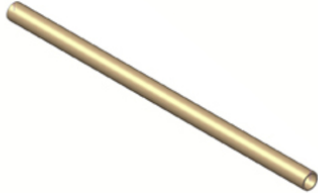

- Guide tube for use on a liner when welding or brazing soft or alloyed wire
- Suitable for wire feeders in the drive 4X HP/LP /Basic and drive 4X IC HP/LP/Basic series
- **Recommendation:**
- Use a steel liner with capillary tube to weld hard, unalloyed wire electrodes (steel)
- Use a liner with guide tube to weld or braze soft or alloy wire electrodes
- Suitable for welding machines in the series alpha Q., Phoenix, Taurus and Picomig (except the 180) with eFeed drive unit